

FED. ROAD DIST. NO.	STATE	JOB PIECE NO.	FISCAL YEAR	SHEET NO.	TOTAL SHEETS
6	OKLA.				
DESCRIPTION		REVISIONS		DATE	

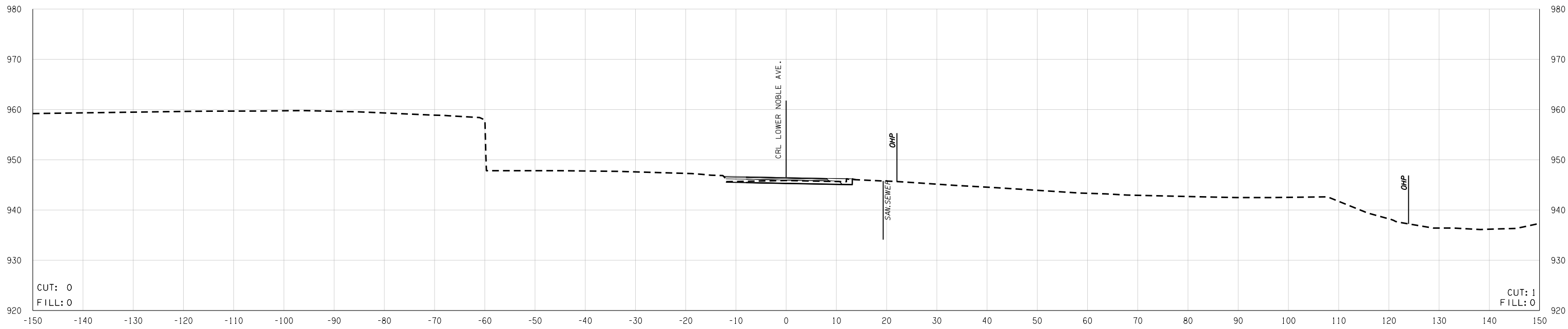

END LOWER NOBLE AVE. CONST.  
3 + 05.51

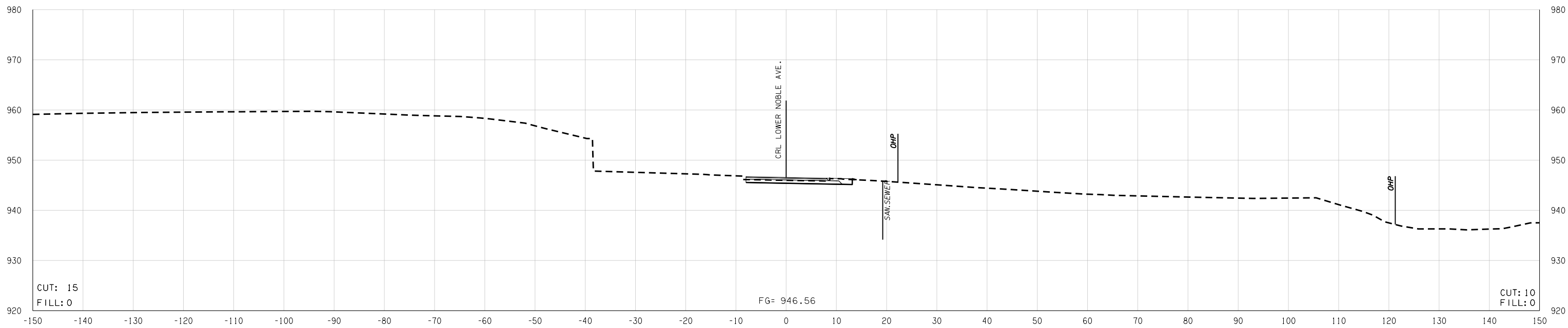

3 + 00.00

LOWER NOBLE AVE.

STATE JOB NO.	21860(04)
LOGAN COUNTY	SHEET NO. X09.1

08-19-16 Y:\Division 4\21860 (04) \Design\21860\_XSEC\_LowerNobleAve\_2.dgn